

ONLY A CHOSEN FEW  
CAN TAKE THIS PATH

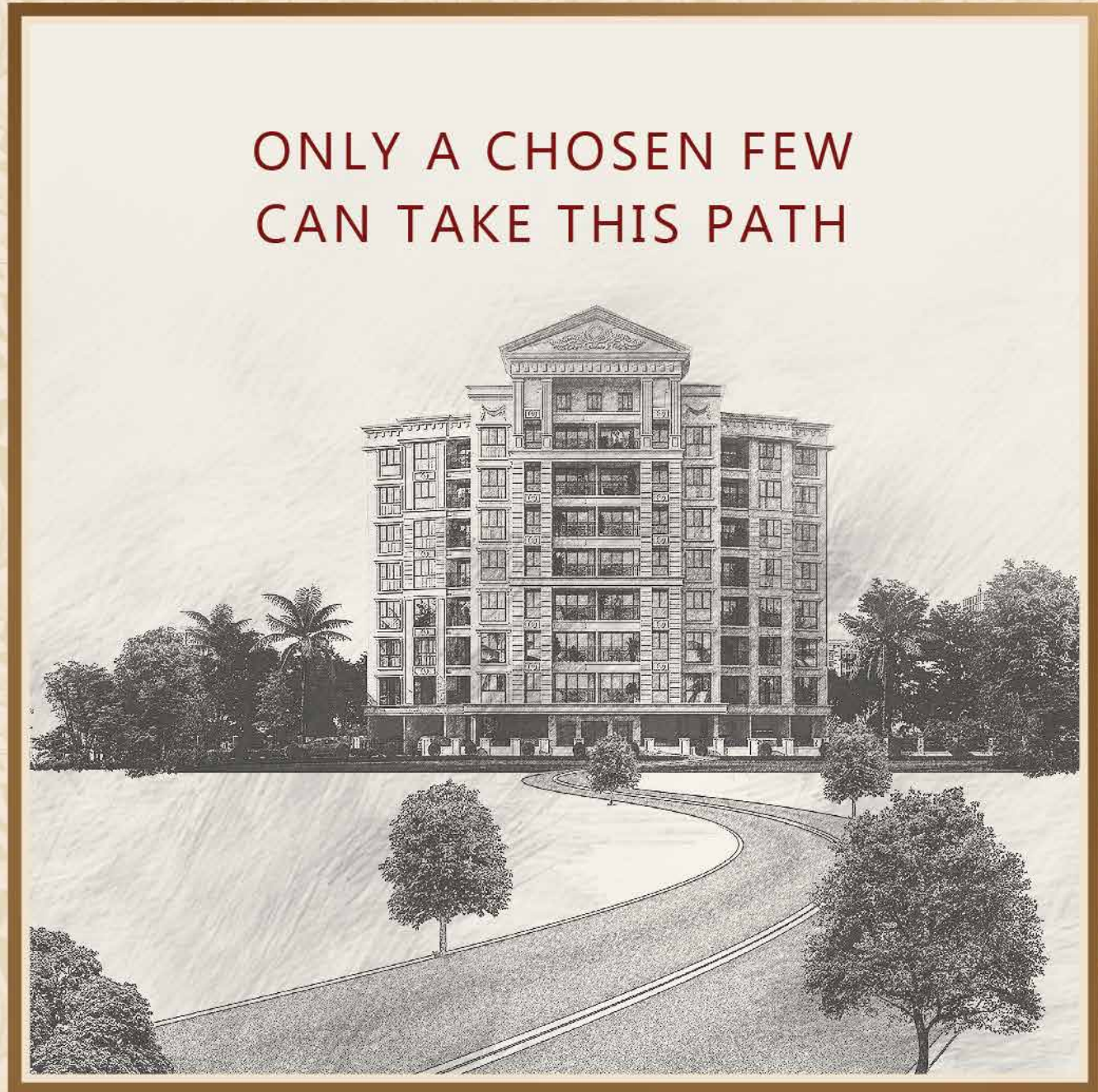

#AddRaunakToYourLife

Raunak Imperial Opp. Platinum Heritage Building, Hiranandani Estate, Patlipada, Thane West.

Disclaimer: This brochure does not constitute any form of an offer or contract of any nature whatsoever between the Promoters/ Developers and the recipient. All transactions shall be subject to the terms and conditions of the agreement for sale to be entered into between the Promoter and the recipient. All images are for illustrative purposes only unless otherwise mentioned. The project has been registered via MahaRERA Registration Number P51700052635, and is available on the website <https://maharera.mahaonline.gov.in>. T&C apply.



RAUNAK  
IMPERIAL



A PRIVATE LANE LEADS  
TO YOUR OWN  
PRIVATE SPACE. RIGHT IN  
THE CENTRE OF LIFE.



*This lane has been waiting for you. It takes you to a home; secluded, quiet and reserved. The path is open for the few of you who appreciate the value of elegance, of peace and of being exclusive. Those who understand the need for being in the centre of life while maintaining your distance, living at your pace.*

*Imperial.*

*In the middle of Hiranandani Estate.  
Yet away from the crowd.*



## A HOME THAT SPELLS HARMONY

*The name Imperial is just so apt. No common road,  
or crowded main avenue for you. A private road takes you  
to its gates; exclusive, private, secluded.*

*Imperial is a seven floor project that is meant to create  
a close-knit community where neighbours know neighbours  
and can form healthy, life-enhancing relationships.*



*The design is a unique fusion of a beautiful designed  
columnar exterior with a Mondrian inspired approach to the facade  
and a look made up of rectangular glass window arrangements.  
The colours are understated with just a touch  
of Grecian architecture to embellish the modern with the classical.*

IMPERIAL.  
IT'S A HOME THAT MAKES  
IT'S OWN PATH



YOUR HOME.  
A CUT AWAY FROM THE REST.



*Each home is designed  
to give that feeling of spread,  
so you can fit in whatever  
you need for the life you desire.  
The layout affords complete freedom  
for the design you have in mind.  
There is an openness that allows  
the breeze in and for the light  
to come through.  
The outlook is bright, whether  
it is your home or your life.*



IMPERIAL  
TRULY A MORE ROYAL LOOK AT LIFE.



*The standout feature is that we have a choice of home configurations. You can choose between 1 or 2 or 3 BHK homes on any floor. Each home comes with the best of international-class fittings, Euro-style tiling and chic accessories. The kitchen is modular, the electricals are high-rated for safety and the bathroom fixtures are top-of-the-line. It's obvious to even the most casual observer that a home here is designed with care.*

# ROOFTOP CLUB MAKE YOUR LIFE TRULY DISTINCT.

*Right as you enter the lobby reception you know this space is truly yours. Take the lift to the Rooftop Club and enjoy the best of amenities. Designed keeping community in mind, here is a place to make friends, relax and celebrate life to its fullest. Whether it's health, past-times, hobbies or parties, the Rooftop Club is where social life meets life goals.*



# CONNECTED TO THE WORLD. DETACHED FROM THE DIN.

*Imperial is coming up in Hiranandani Estate just off the main avenue giving you the kind of connection that makes for a more uplifted life. In five minutes you touch Ghodbunder Road which means any part of Mumbai is just a drive away.*

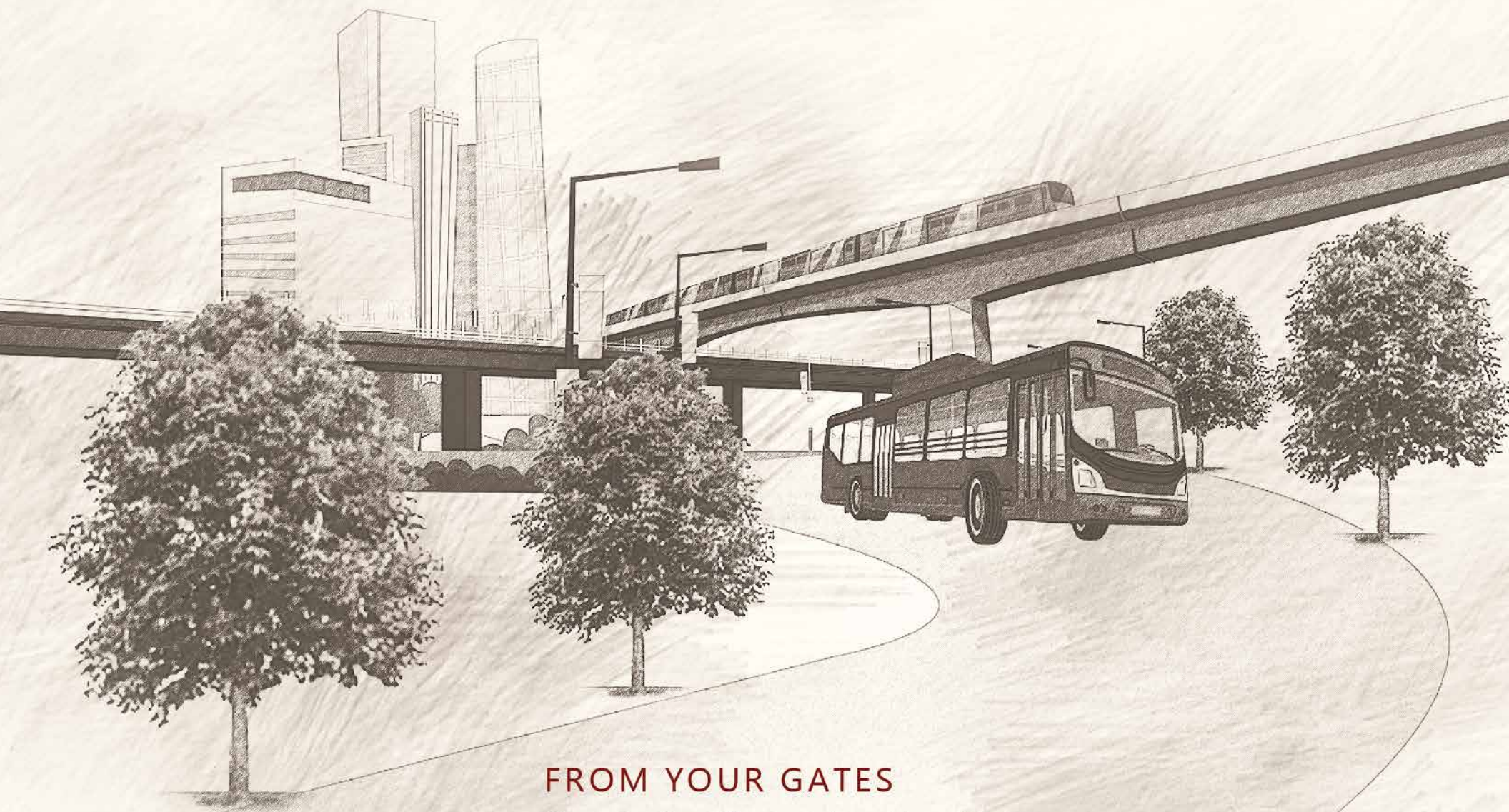

## FROM YOUR GATES

- Upcoming East-West tunnel corridor - 10 minutes*
- Upcoming Ghatkopar-Colaba-Andheri Metro station - 5 minutes*
- Vasai Creek bridge - 10 minutes*
- Thane station - 20 minutes*





# IMPERIAL. A LIFE SET APART.

*Your home is walking distance from one of the buzzing lifestyle zones of Thane. Nature parks, hospitals, schools, shopping centres and entertainment hotspots are all within a ten minute walking radius. Yet you don't feel the noise and the stress of the city.*





## RAUNAK GROUP. ON A PATH TO THRIVING COMMUNITIES.

*Our driving thought is to create communities that live enriched lives with each family at the centre of nature, lifestyle, infrastructure and personal growth. Since 1980 we have been working on changing the very essence of our cities in Mumbai, Thane and Kalyan, leading to holistic living, care for the environment and a vibrant society. Our values dictate that we deliver a true return on investment because our customers' lives come first for us.*

**No.4** REAL ESTATE DEVELOPER\*

**60,94,047** SQ. FT. DELIVERED

**7,530** HAPPY FAMILIES

**150+** BUILDINGS DELIVERED

**94,00,000** SQ. FT. UNDER DEVELOPMENT

**100%** ON-TIME DELIVERY



**VIRAJ TOWER**  
4BHK, 5BHK  
Pokharan Road No. 2, Thane (W)



**RAUNAK WHITE HOUSE**  
3 BHK, 4 BHK, 5 BHK  
Hiranandani Estate, Thane (W)



**RAUNAK MAXIMUM CITY**  
1BHK, 2BHK  
Ghodbundar Road, Thane (W)



**RAUNAK 108**  
1BHK  
Kasarvadavali, Thane (W)



**RAUNAK CENTRUM**  
2BHK  
Off BKC Connector, Sion, Mumbai



**UNNATHI WOODS SUPREME**  
2BHK Luxury Apartment  
Ghodbundar Road, Thane (W)



**RAUNAK RESIDENCY**  
1BHK, 2BHK  
Pokharan Road No. 1, Thane (W)



**RAUNAK SERENE**  
1BHK, 2BHK  
Pokharan Road No. 1, Thane (W)

TYPICAL FLOOR PLAN



1 BHK JODI FLOOR PLAN

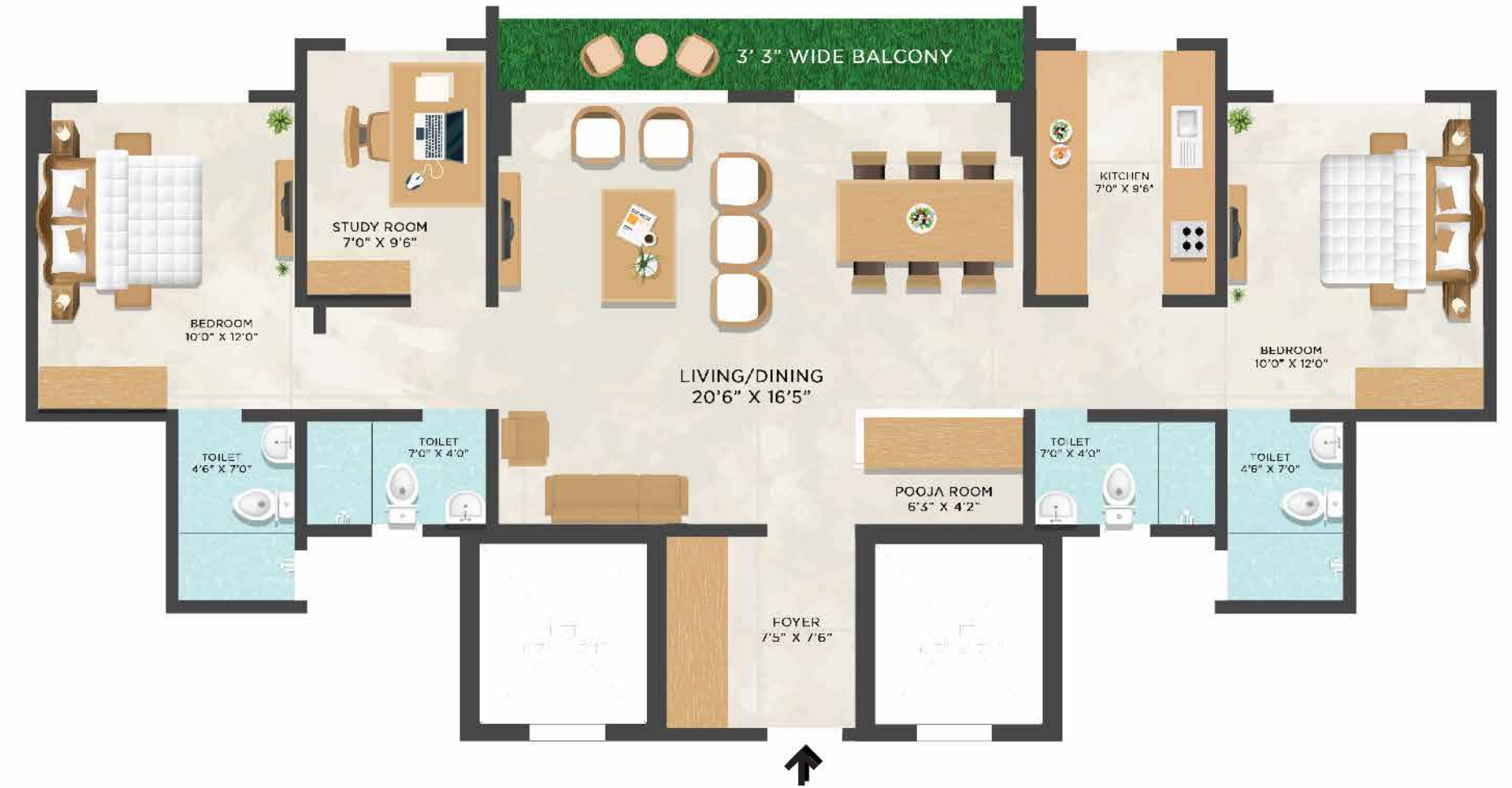

### 3 BHK FLOOR PLAN

RERA CARPET 987 SQ.FT



### 2 BHK FLOOR PLAN

RERA CARPET 720 SQ.FT



# 1 BHK FLOOR PLAN

RERA CARPET 498 SQ.FT

